

# HERD FD18L2-02 Installation Procedure

- This document shows how to install your new Truck Guard onto your truck.
- Ensure that you have completely read and understand document **S017 - Safety** before beginning this installation procedure.
- You will require the following tools and supplies for installation:

Screwdrivers	Pliers	Wire Ties	Level
Wrenches (various sizes)	Sockets (various sizes)	Socket Wrenches (various sizes)	



Figure 1c: Remove front fasteners (Passenger Side shown)

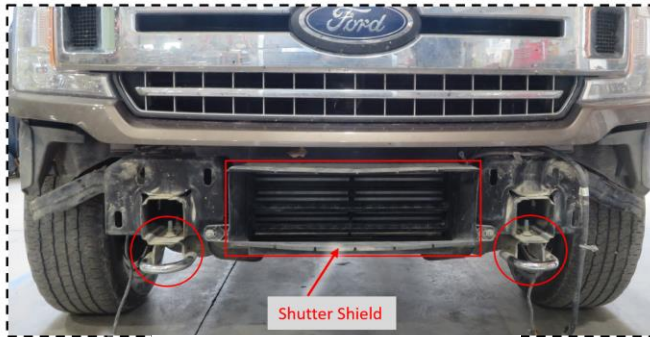

Figure 1e: Remove OEM tow loops and shutter shield



Figure 1d: Remove fastener behind OEM bumper (Driver Side shown)



Figure 1a: Remove plastic covers

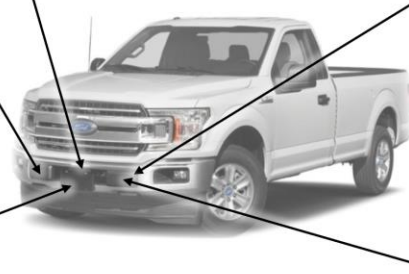

Figure 1b: Remove CAS Radar (if applicable)

Figure 1: Remove the OEM front bumper (Your Truck may not be exactly as shown)

## **I. Removing the OEM front bumper**

1. Unplug the wiring harness and detach the block heater cord (if applicable) from the OEM front bumper before removing it.
2. Remove plastic covers (1 per side) located on the front bumper as shown in Figure 1a.
3. Unplug and remove the CAS radar (if applicable) on the driver side of the front bumper, see Figure 1b.
4. Remove the front fasteners (2 per side). The fasteners' locations are shown in Figure 1c.
5. Remove the fastener (1 per side) from the back of the bumper as shown in Figure 1d. Next, remove the OEM front bumper.
6. If the truck comes with OEM tow loops, remove the tow loops together with OEM fasteners for later usage, see Figure 1e.
7. Remove shutter shield, the plastic frame around the shutter (if applicable), see Figure 1e. To see how the shutter looks after the shield is removed, please refer to Figure 2a (page 3).



Figure 2a: Submount Installation

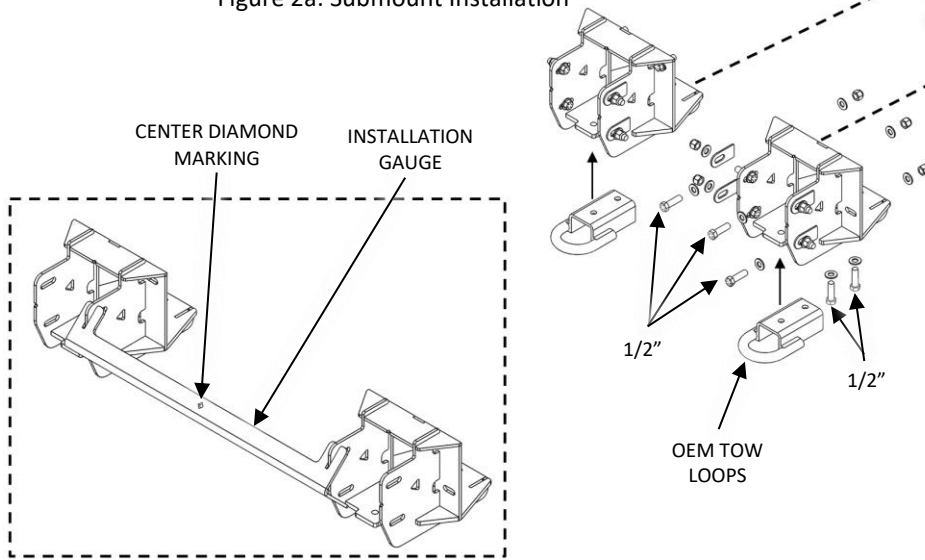

Figure 2b: Using the Installation Gauge

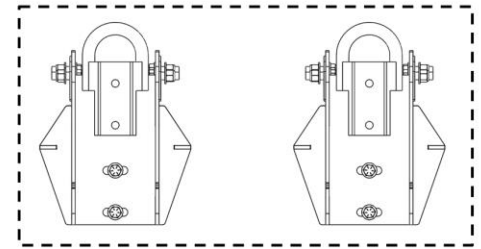

Figure 2c: OEM tow loops orientation (Bottom view)

Figure 2: Installing the Submounts

## II. Installing the Submounts

1. Install the Submounts as shown in Figure 2a, using provided fasteners (1/2"), to the front and bottom of the truck frame, fasten loosely.
2. Use the Installation Gauge to position the Submounts; the center diamond marking should line up with the center of the truck, see Figure 2b.
3. With the Installation Gauge still in position, tighten all mounting fasteners. **Torque the 1/2" fasteners to 96 lb-ft.**
4. Remove the Installation Gauge.
5. Install the OEM tow loops (if applicable) to the bottom of the Submounts with OEM fasteners as shown in Figure 2c.

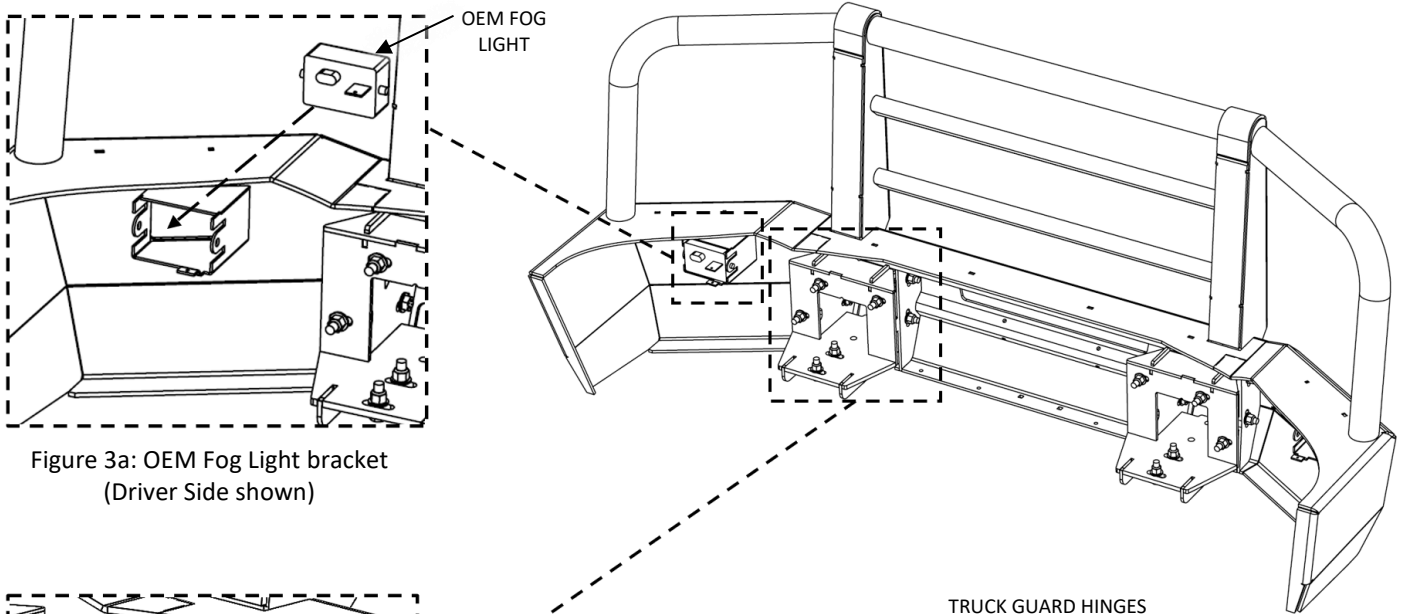

Figure 3a: OEM Fog Light bracket  
(Driver Side shown)

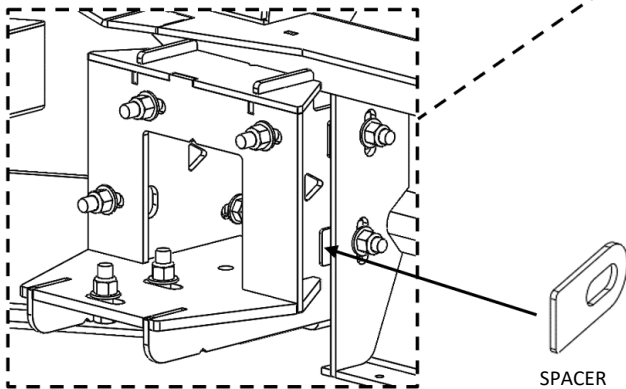

Figure 3b: Truck Guard installation  
(Driver Side shown)

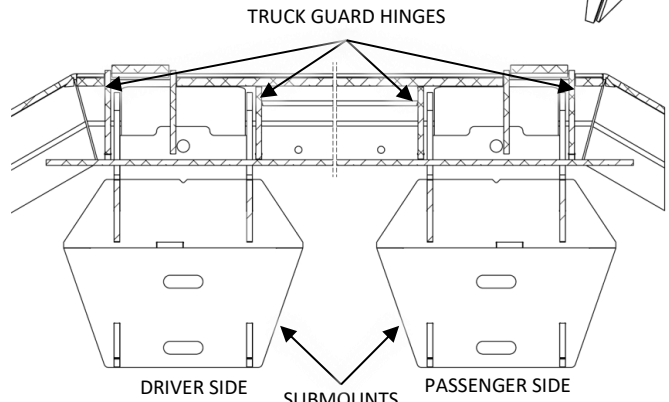

Figure 3c: Submounts position

Figure 3: Installing the Truck Guard (view from behind)

### III. Installing the HERD Truck Guard

1. Remove the OEM fog lights from the OEM front bumper (if applicable).
2. Install the OEM fog lights on the HERD Truck Guard (from the front of the Truck Guard) as shown in Figure 3a.
3. Attach the HERD Truck Guard to the Submounts. Use the provided Fasteners (1/2") and Spacers (1/16" and/or 1/8") if necessary. **Follow the orientation shown in Figure 3b and Figure 3c.** Adjust the HERD Truck Guard if necessary. Tighten all mounting fasteners after adjustment, and **torque to 96 lb-ft.**
4. Plug the wiring harness into each fog light and the truck's wiring harness (if applicable). Clean up loose wiring (harness and block heater cord if applicable) with zip ties.

**Important: Check mounting points' hardware after the first 5000 km and every 3-6 months. Re-torque if necessary.**