

- This document shows how to install your new Grille Guard onto your truck.
- Ensure that you have completely read and understand document **S017 - Safety** before beginning this installation procedure.

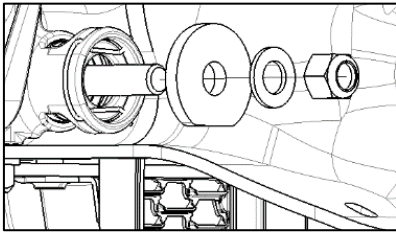

Figure 1b: Rear view of tow receiver

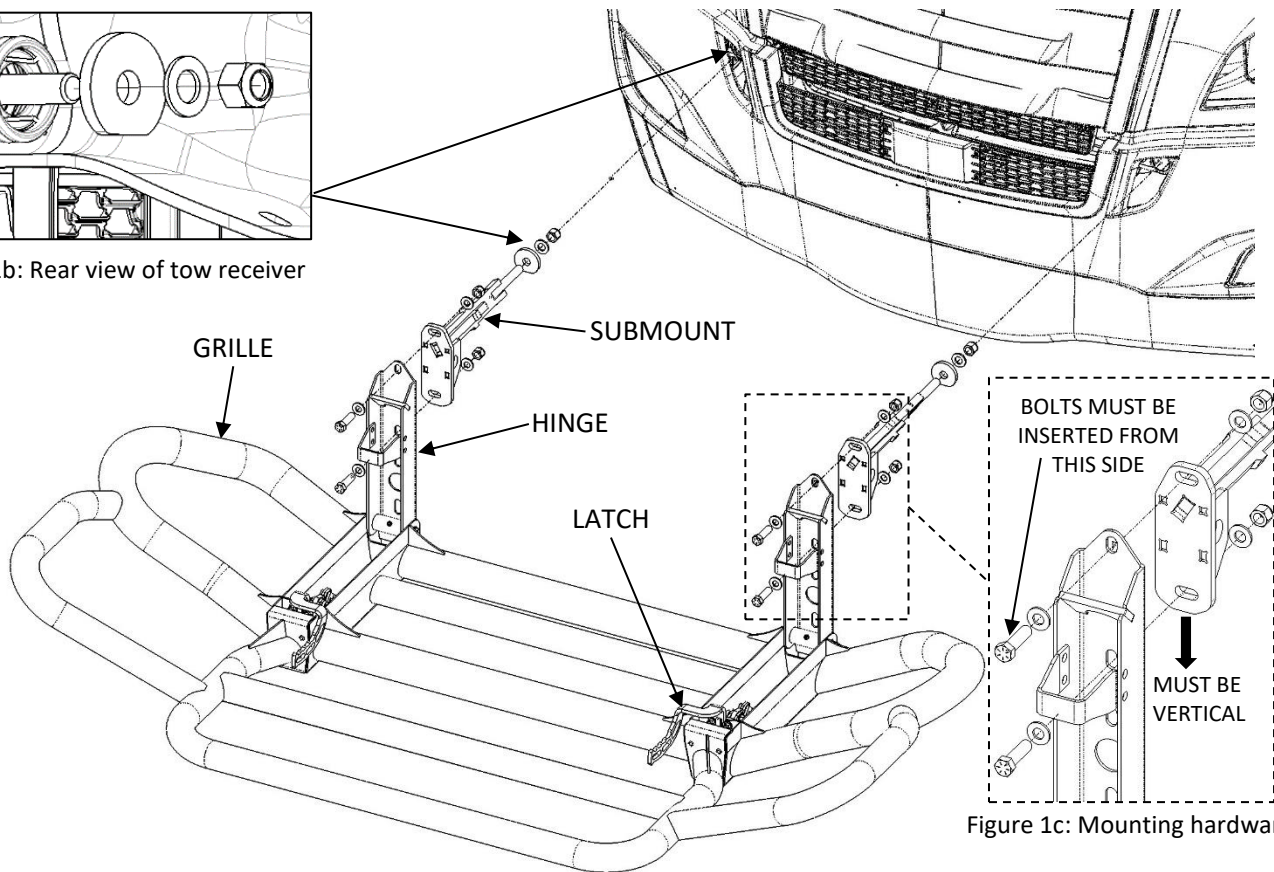

Figure 1c: Mounting hardware

Figure 1a: Grille Guard installation (Your Grille Guard may not be exactly as shown)

1. Insert Submounts into truck's tow receiver. **Submounts must be vertical** as shown in Figure 1c.
2. Open hood of truck. From inside front wheel wells, secure driver and passenger side Submounts with fasteners shown in Figure 1b:
 - a) Tighten lock nut until Submount is fully seated against front face of tow receiver.
 - b) Loosen lock nut until large washer becomes slightly loose, then **check if the Submount is vertical**.
 - c) **Torque lock nut to 240 ft-lb**. If there is no access for a torque wrench, turn lock nut 3/4 of a turn after the lock nut is seated against the washers.
3. Lay Grille flat on ground in front of truck on a pallet or protective sheet.
4. Open driver side Hinge and lift to driver side Submount. Hand tighten upper hardware shown in Figure 1a (**do not fully tighten**). Repeat for passenger side. **Ensure bolts are inserted from front (Hinge side) as shown in Figure 1c**.
5. Assemble lower hardware on both sides. Hand tighten hardware (**do not fully tighten**). After all four fasteners have been assembled, **torque to 110 ft-lb**, starting with upper hardware.
6. Please proceed to document **S021 – Grille Guard New Style Latch Adjustment Procedure** for Latch adjustment.

Important: Check mounting point's hardware after the first 5000 km and every 3-6 months. Re-torque if necessary.