

SKU #	Truck Model
KW22C4-02	Kenworth T880

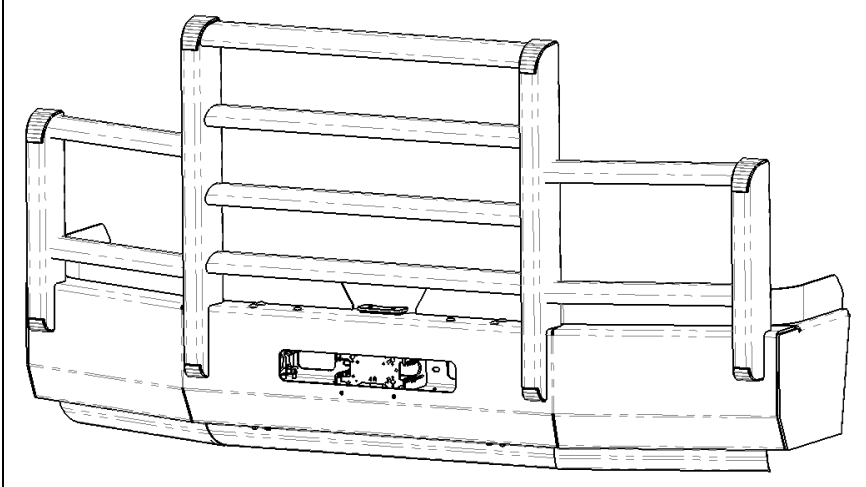

Thank you for choosing HERD!

For assistance call
1-888-543-4373
www.HERD.com

Important

- Herd Truck Guards are vehicle "Make & Model" specific. Use of a Truck Guard on a vehicle other than the model it was designed for will constitute improper use of the product and may void warranty.
- Unless otherwise specified, Grade 8 or Class 10.9 hardware is to be used. For the purposes of these instructions, OE hardware means the truck's original factory hardware.
- For further detail of warranty coverage and warranty repair information visit www.HERD.com.

General Safety

- Take time to fully read the instructions before installing the Herd Truck Guard.
- At all times exercise safe work shop practices, wear steel toe boots and safety glasses during installation.
- Parts and components of the Herd Truck Guard can be heavy, handle with care to avoid injuries.
- Respect power tools and use them as advertised.

HERD North America Inc.
2168 Springfield Road
Box 28, Group 525, RR5
Winnipeg, MB. Canada R2C 2Z2

Parts and Tools Referenced in this Installation Guide

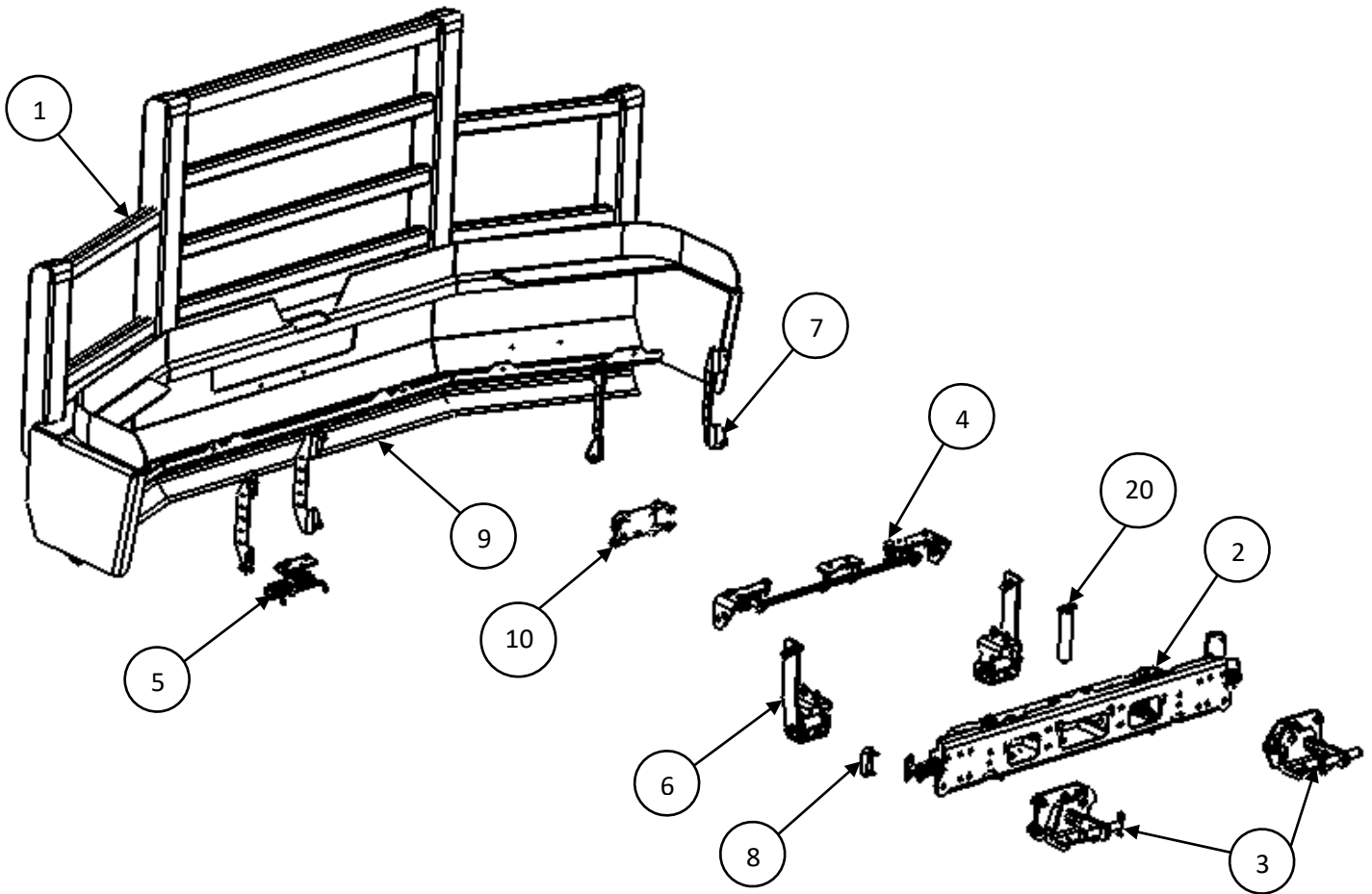

Parts and Hardware Included

Item No	Part No	Description	Qty
1	2P0027	WLDMT-TRUCK GUARD PB11C4-02	1
2	100062	ASSY-UNIVERSAL BRACKET	1
3	1K0021	KIT – MOUNTING KW22	1
4	100027	C4-02 SLAM LATCH ASSEMBLY	1
5	100021	ASSY-LIFT ASSIST	1
6	100054	ASSY-HINGE	1
7	100058	KIT-CHANNEL STRUT	4
8	400014	KIT-RUMBER 20 MM	2
9	400040	KIT-AIR DEFLECTOR PB11	1
10	100046	KIT-CAS BRACKET	1
11	500167	NUT-NYLOCK 1/2-13 NC GR8 YZP	10
12	500263	WASHER-FLAT 1/2X1-1/2OD 1/4THICK	10
13	500206	WASHER-FLAT 1/2 SAE GR8 YZP	10
14	500169	NUT-NYLOCK 1/4-20 NC GR8 YZP	12
15	500208	WASHER-FLAT 1/4 SAE GR8 YZP	24
16	500095	BOLT-HEX 1/4-20X1 NC GR5 WZP	12
17	500173	NUT-NYLOCK 3/4-16 NF GR8 YZP	2
18	500211	WASHER-FLAT 3/4 SAE GR8 YZP	2
19	500085	BOLT-HEX 1/2-13X1-3/4 NC GR8 YZP	10
20	100049	WLDMT-TOW PIN	1

Installation Procedure

1. Remove the 6 OEM bolts shown and remove the OEM bumper. If factory center tow pin is an option on the truck, remove it as well. If the truck has a collision mitigation radar sensor, unplug and remove it. Refer to the HERD radar sensor installation guide (S009) to re-install your sensor.

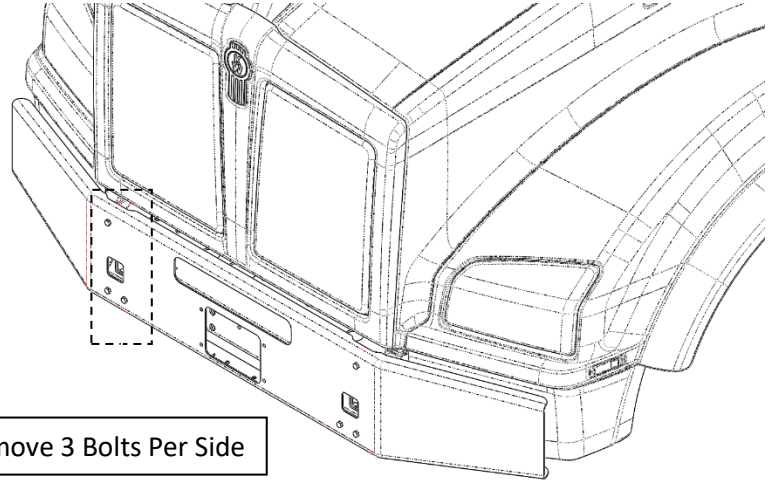

Figure 1 – OEM Bumper Uninstall

2. Remove OEM nuts and washers shown from underneath the back side to remove the OEM bumper mount plates. Keep OEM nuts and washers to install later. Leave bolts in place.

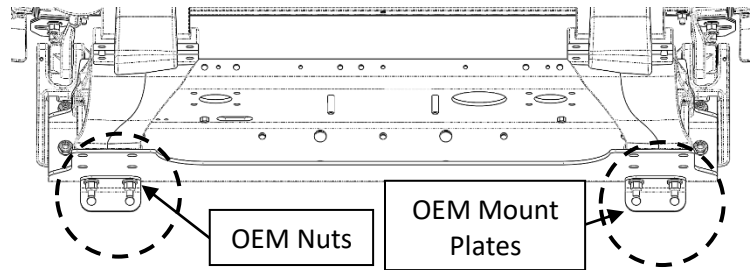

Figure 2 – OEM Bumper Mount Removal

3. Install tow receiver mounts (From Item 3) into truck tow receivers. Remove the OEM bolts indicated by arrows.

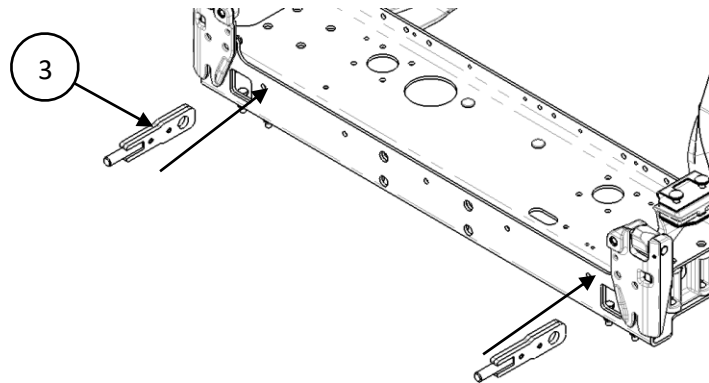

Figure 3 – Tow Receiver Mounts Installation

Installation Procedure

4. Install clevis pins (From Item 3) through OEM tow receiver holes and HERD tow receiver mounts. Install hair pins into the clevis pins from the KW22 Mounting Kit (Item 3).

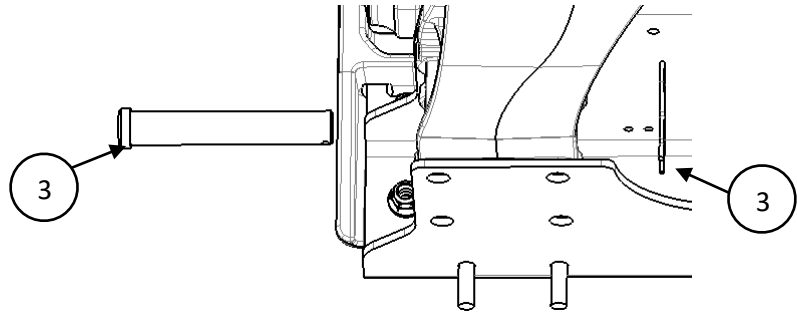

Figure 4 – Tow Receiver Clevis & Hair Pins Installation

5. Install driver side and passenger side mounting brackets (Item 3). Use $\frac{3}{4}$ " flat washers (Item 17) and nylon locking nuts (Item 16) to attach the mounting brackets to the tow receiver mounts, torque to 150 lb-ft. Use the OEM washers and bolts saved from Step 2 on the bottom of the mounts, torque to 110 lb-ft.

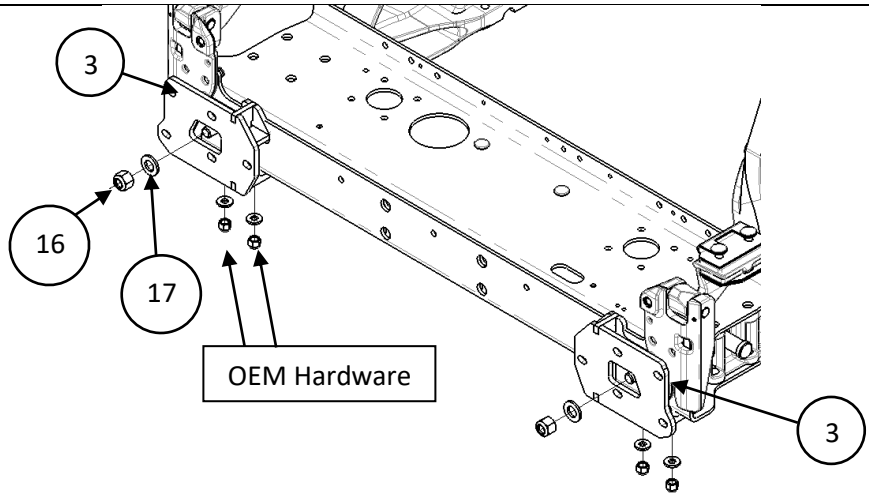

Figure 5 – Side Mounting Bracket Installation

6. Open truck guard by pulling on the handle. Using lift, raise the Truck Guard (Item 1) and universal bracket (Item 2) and attach to side mounting brackets (Items 3). Do not tighten the nuts.

Note:

If installer does not have a lift available, truck guard can be disassembled from the universal bracket to simplify installation as shown in step 7, otherwise proceed to step 8.

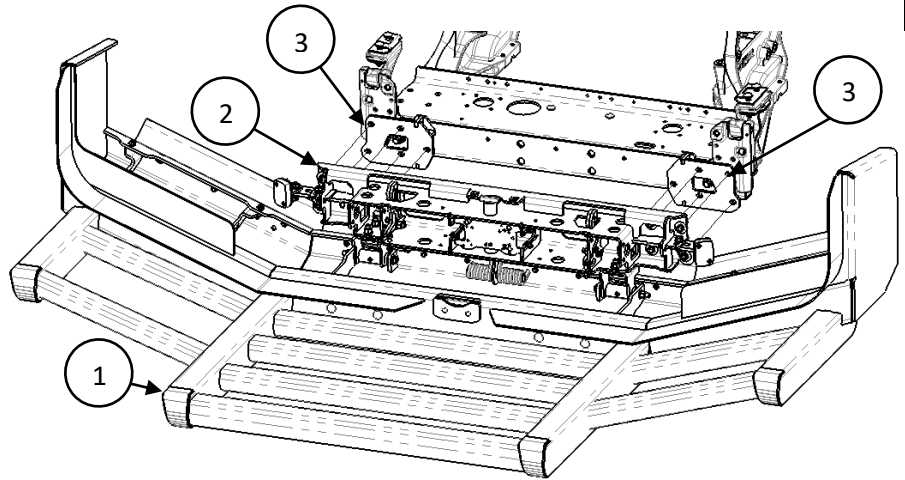

Figure 6 – Universal Bracket Installation

Installation Procedure

7. a) Ensure truck guard is closed. From underneath the truck guard, remove the 3/8" hardware securing the lift assist spring and slide off spring form the lift assist (item 5)

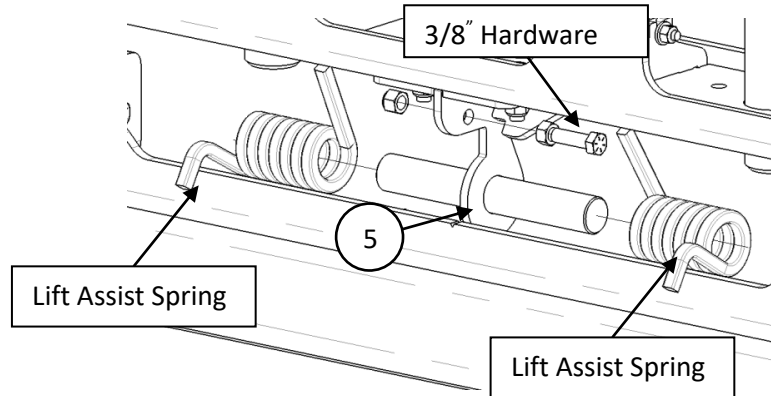

Figure 7a – Bracket and Lift Assist Disassembly

- b) Once the springs are removed, carefully open the truck guard using the slam latch. Remove the 1/2" hardware securing the truck guard to the universal bracket. Remove truck guard and set aside on cardboard. Now the bracket is isolated for mounting without a lift.

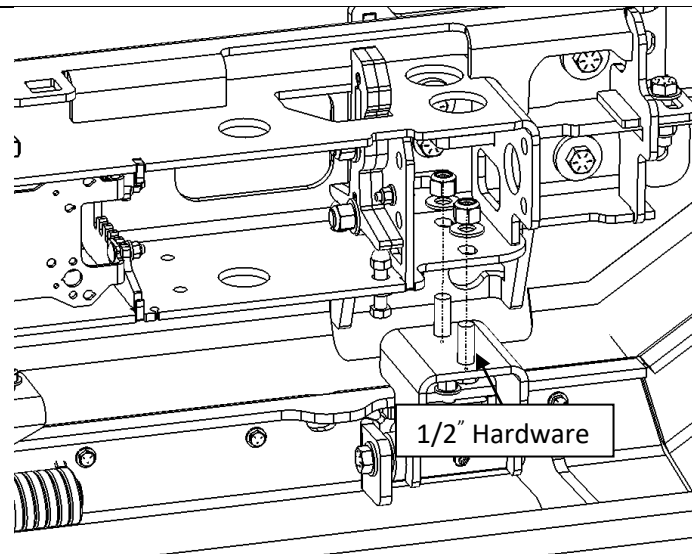

Figure 7b – Bracket and Truck guard Disassembly (Driver Side Shown)

8. Attach universal bracket (Item 2) to mounting brackets (Items 3). Level the bar to the truck and then tighten the fasteners (110 lb-ft).

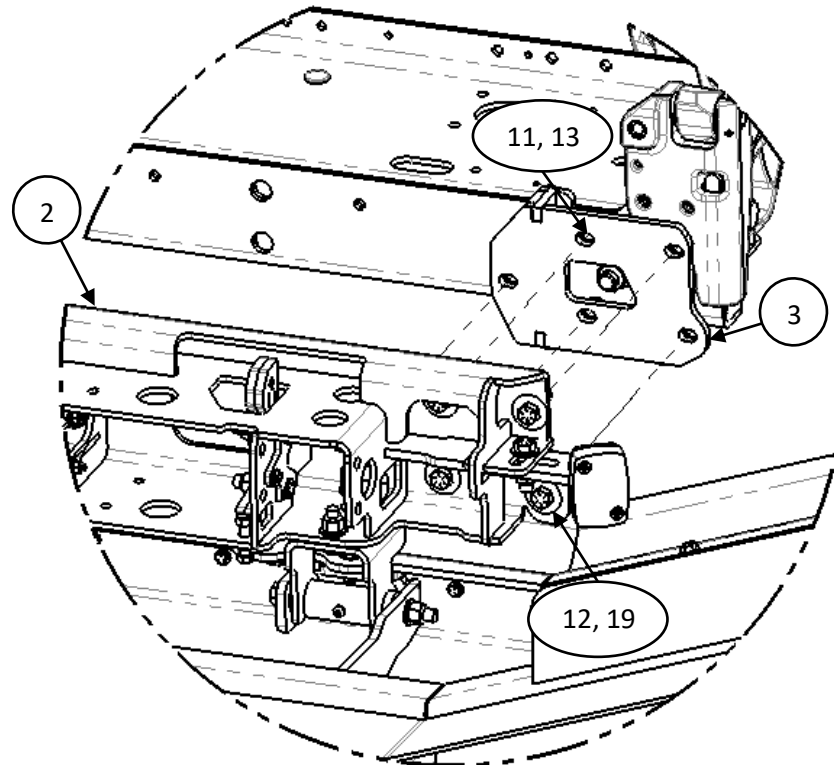

Figure 8 – Universal Bracket Side Mounting Location (Driver Side Shown)

9. If truck guard was disconnected from the universal bracket in step 7, reverse the procedure to mount truck guard back onto the bracket.
- a) First ensure the truck guard hinges are open.
 - b) Attach using previously removed 1/2" bolts until the hinge just slightly touches the bracket.
 - c) Close the truck guard and ensure the latch engages.
 - d) Open the truck guard and tighten the bolts until they are snug.
 - e) Close the truck guard again to ensure the latches engage properly.

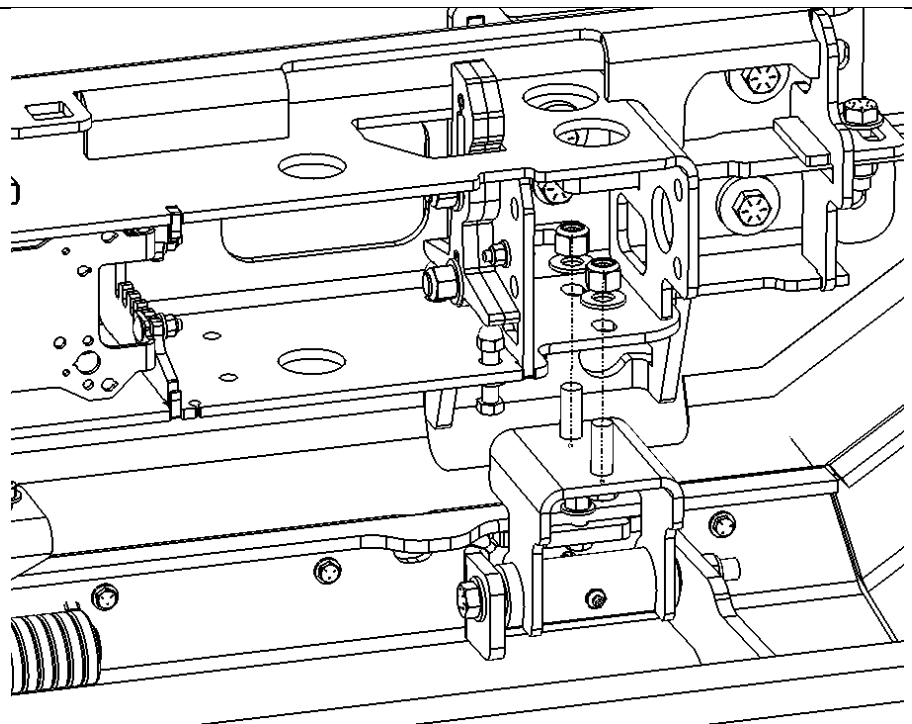

Figure 9.1 – Bracket and Lift Assist Reassembly

Installation Procedure

f) Fully tighten the ½" hardware to 110 ft·lb. Latches may need to be adjusted, refer to Slam Latch Adjustment guide (S012).

g) Close the truck guard and slide springs onto the lift assist shaft, ensuring that spring arms are inserted into slots of truck guard. Reinsert 3/8" hardware securing the lift assist springs.

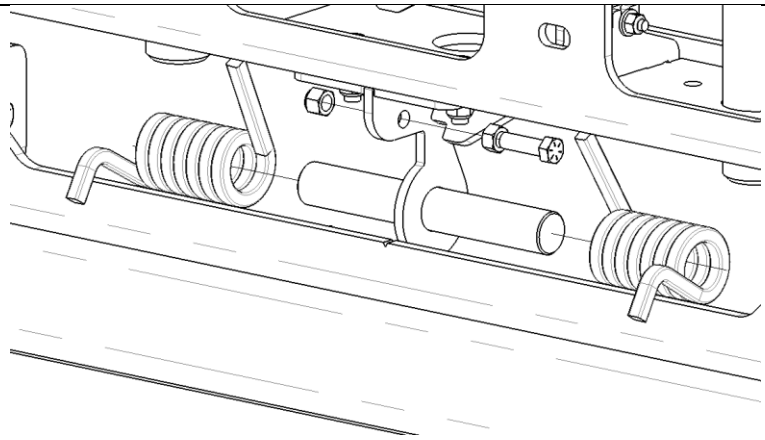

Figure 9.2 – Bracket and Lift Assist Reassembly

10. Close the truck guard and check fitment. Truck guard position can be adjusted side to side and up or down as required. Once fitment is confirmed, tighten all mounting bolts to 110 lb-ft (10 bolts total).

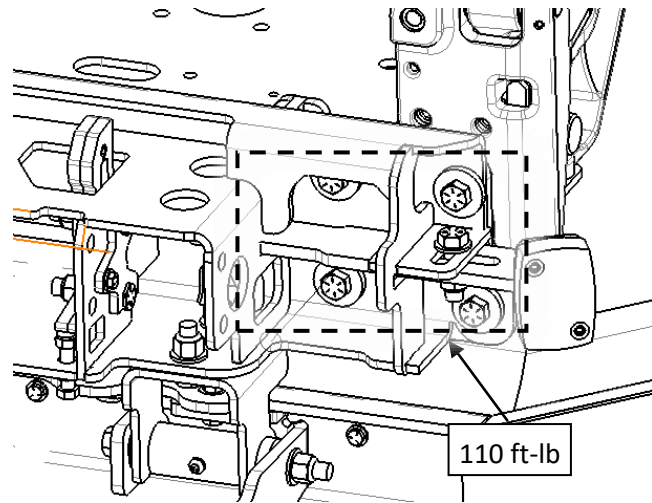

Figure 10 – Side Bracket Bolt Torque Specs (Driver Side Shown)

11. Install the air deflector (Item 9) to the truck guard (Item 1) as shown using the supplied hardware (Items 14, 15, 16).

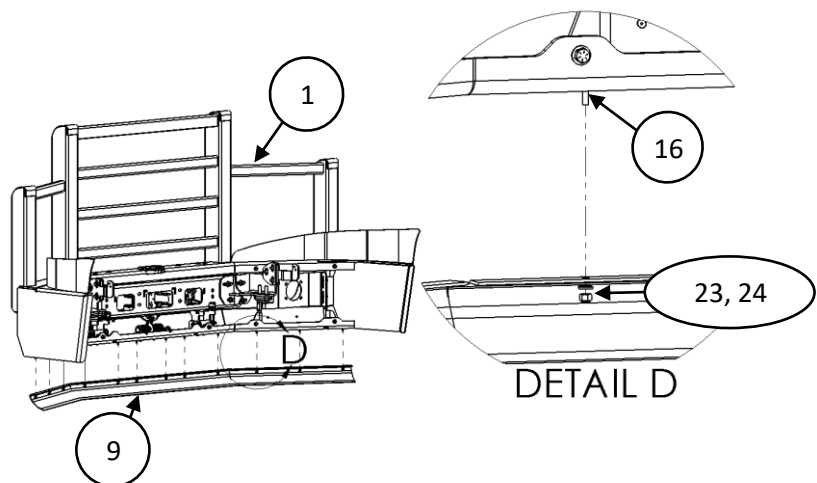

Figure 11 – Air Deflector Installation

Installation Procedure

12. Install radar sensor, if truck is equipped with one. Refer to the HERD radar sensor installation guide (S009) to re-install your sensor.

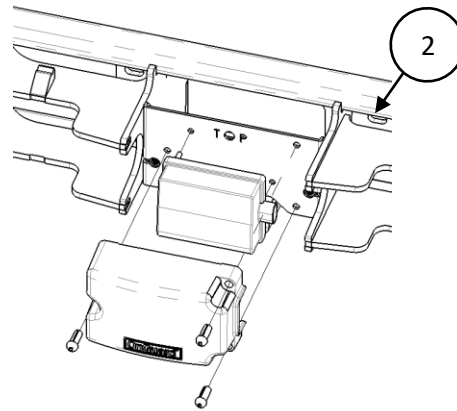

Figure 12 – CAS Unit Installation

Important

- Check mounting points after the first 5000 km and every 3-6 months.
- This truck guard is equipped with Herd Slam Latch which requires periodic adjustment. Refer to Slam Latch Installation adjustment instructions (S001) to properly adjust your Slam Latch.