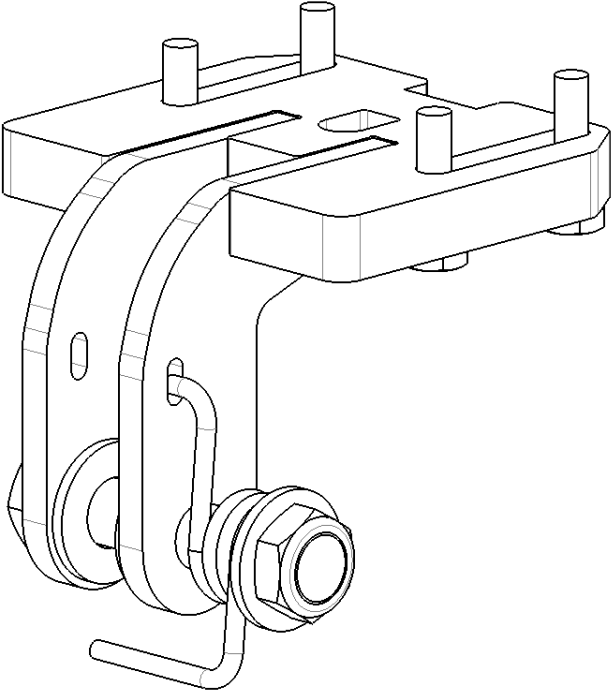

Thank you for choosing
HERD!

For assistance call
1-888-543-4373
www.HERD.com

Product	Series
Slam Latch Hanger Kit	C4
	

Important

- Herd Bumpers are vehicle "Make & Model" specific. Use of a bumper on a vehicle other than the model it was designed for will constitute improper use of the product and may void warranty.
- Unless otherwise specified, Grade 8 or Class 10.9 hardware is to be used. For the purposes of these instructions, OEM hardware means the truck's original factory hardware.
- For further detail of warranty coverage and warranty repair information visit www.HERD.com.

General Safety

- Take time to fully read the instructions before installing the Slam Latch mechanism.
- At all times exercise safe work shop practices, wear steel toe boots and safety glasses during installation.
- Parts and components of the Herd bumper can be heavy, handle with care to avoid injuries.
- Respect power tools and use them as advertized.

Parts referenced in this instruction

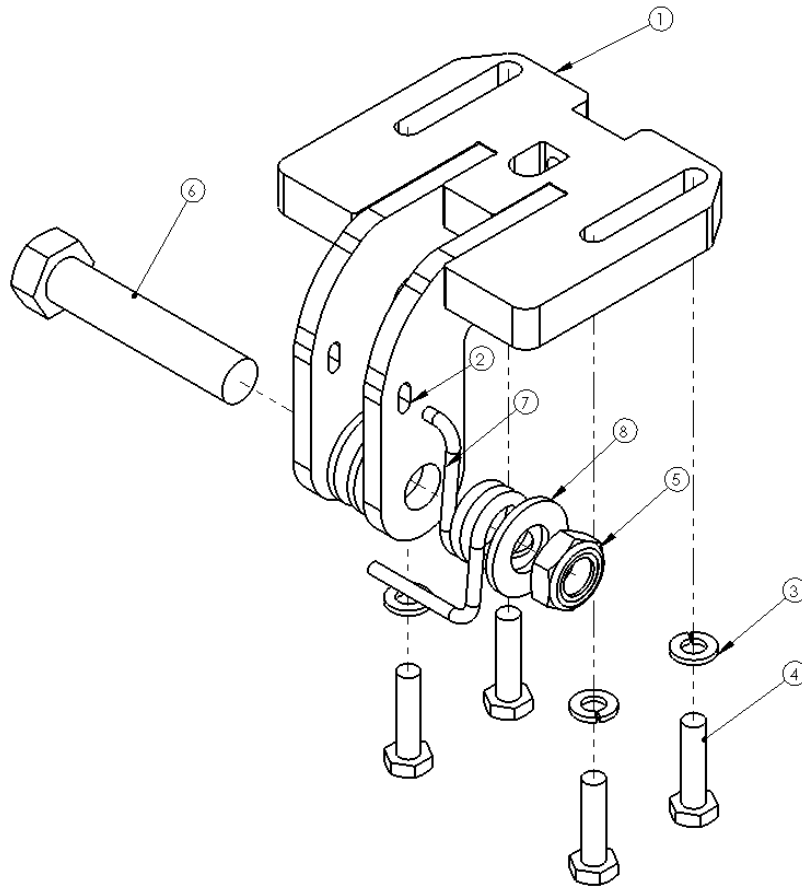

Parts and hardware included

Item No	Part No	Description	Qty
1	1MP093	PLATE, C4 SLAM LATCH ADJUSTING	2
2	1MP003	PLATE, C4 HANGER PIVOT	4
3	500291	WASHER - HELICAL SPRING LOCK 1/4 WZP	8
4	500095	BOLT-HEX 1/4-20X1 NC GR5 WZP	8
5	500168	NUT-NYLOCK 1/2-13 NC GR8 YZP LOW HT	2
6	500088	BOLT-HEX 1/2-13X2-1/2 NC GR8 YZP	2
7	1-MC-TS.70	SPRING, 0.142WD TORSION	2
8	500206	WASHER-FLAT 1/2 SAE GR8 YZP	6

Installation Procedure

Important

- Steps 1 through 6 document the installation procedure for the Herd Slam Latch. The Slam Latch requires periodic adjustment. For instructions on how to properly adjust your Slam Latch, proceed to step 7.

1. If the Herd bumper is already installed on a truck, open the bumper. Remove Slam latch handle by unfastening the ¼" hardware.

NOTE: Keep the ¼" hardware for later use.

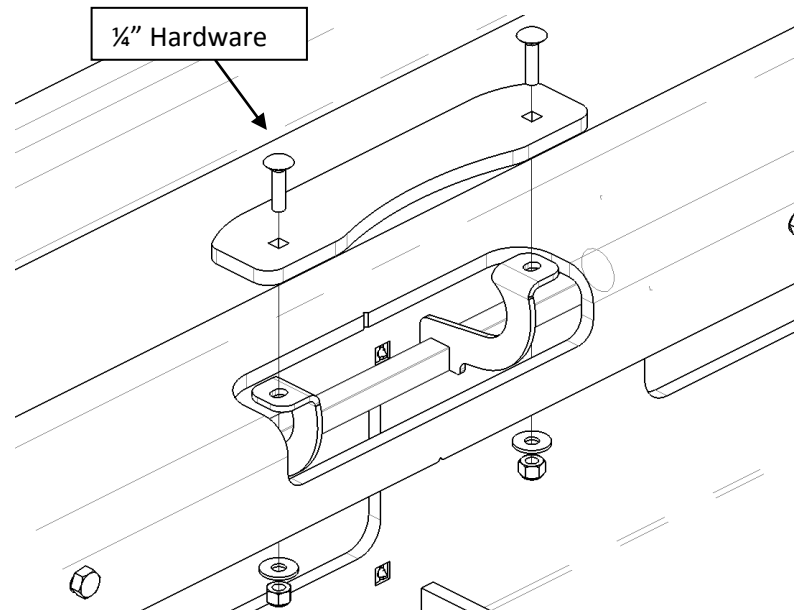

Figure 1 – Slam Latch Handle Removal.

2. First, unfasten the Adjustment Bolt and Adjustment Collar from the slam latch hanger subassembly, leaving it loose in the bumper. It will be reused with the replacement hanger.

Next, unfasten the four ¼" bolts and spring lock washers from both the passenger and drivers sides and remove the Slam Latch.

NOTE: The Adjustment Bolt and Adjustment Collar must be kept for use with the new Slam Latch Hanger.

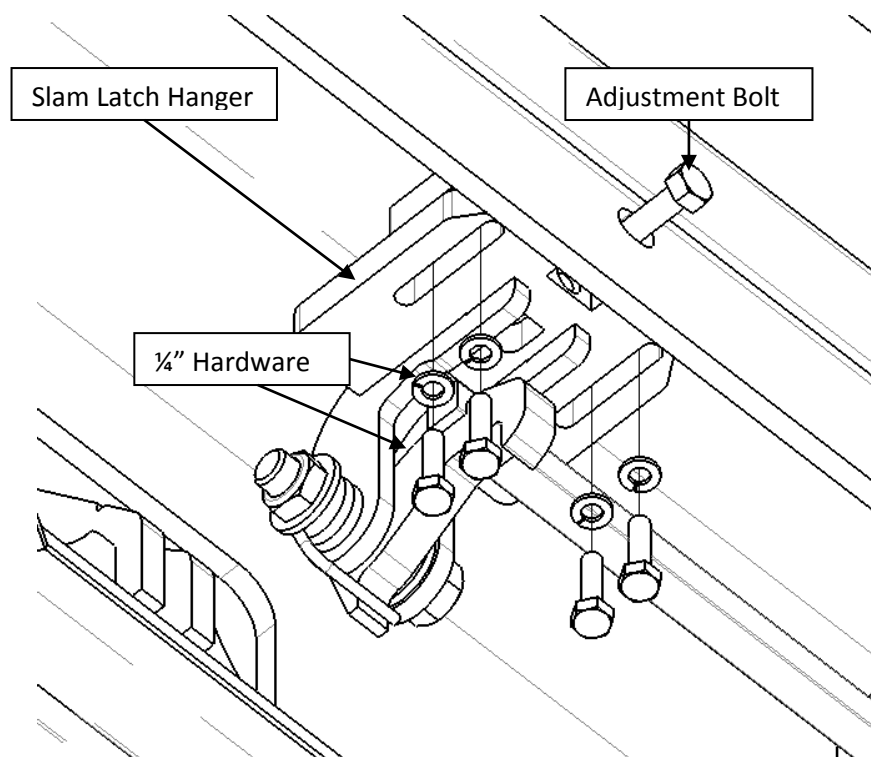

Figure 2 – Slam Latch Hanger Assembly Removal (passenger side shown).

Installation Procedure

3. Next, disengage the Slam Latch Hanger from the Slam Latch Bar by removing the Hardware shown. Do this for both driver and passenger sides.

NOTE: Keep the Slam Latch Bar for later use. As you are only replacing the Slam latch Hanger assembly.

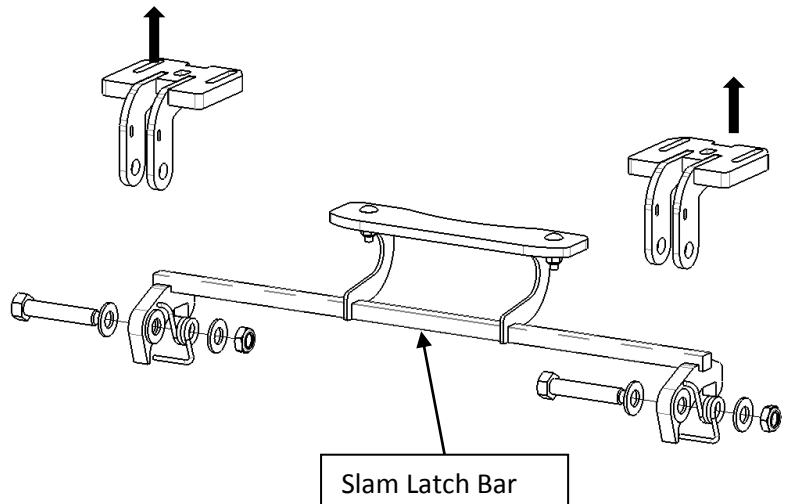

Figure 3 – Slam Latch Hanger Assembly Removal (driver's side shown).

4. Install New Slam Latch Hanger to Slam Latch Bar with the provided hardware (Items 5, 6, 7 & 8). Do this for both driver and passenger sides.

NOTE: Do not over tighten. Once assembled, the hardware must allow for relative rotation between claw and hanger.

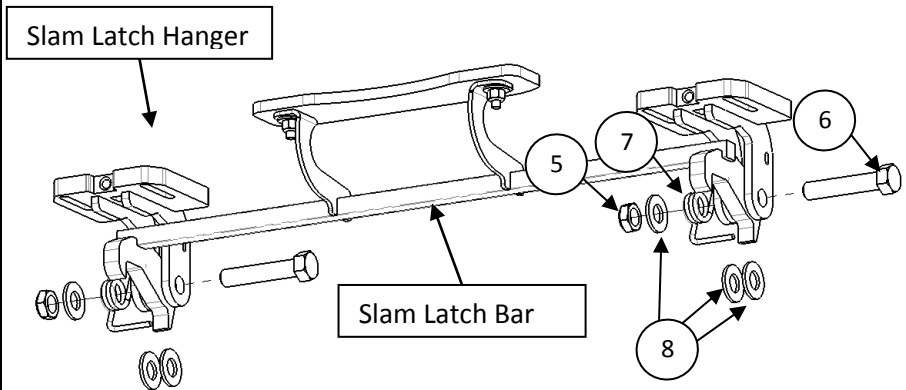

Figure 4 – Slam Latch Bar Reassembly.

5. Mount the New Slam latch hanger and bar assembly onto the HERD bumper and hand tighten hardware.

Next insert the Adjustment Bolt and Adjustment Collar that was kept from step 2.

Tighten the Collar so that the head of the Adjustment bolt is held snug against the bumper. This step is crucial for the adjustment process.

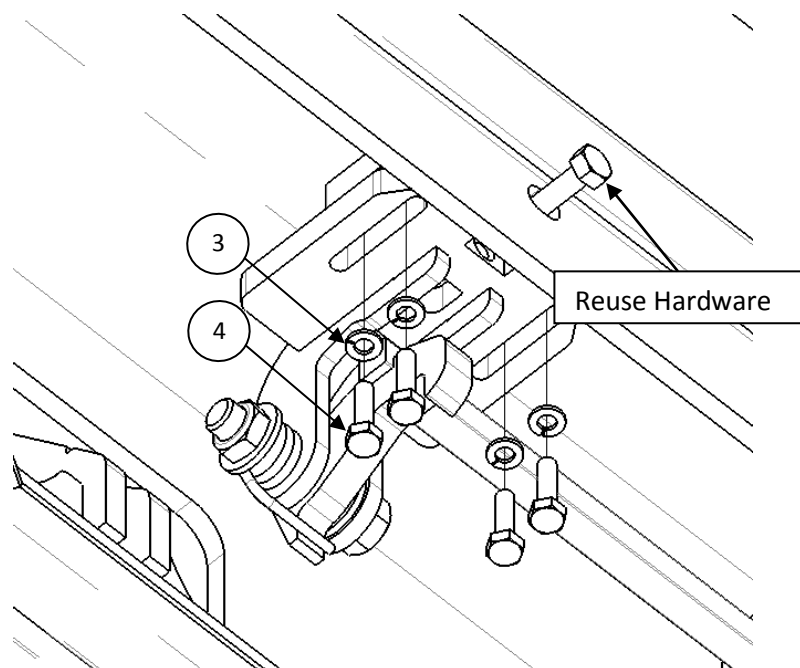

Figure 5 – Slam Latch Hanger Reassembly (passenger side shown).

Installation Procedure

6. Reassemble the Slam latch handle using the $\frac{1}{4}$ " hardware kept from step 1.

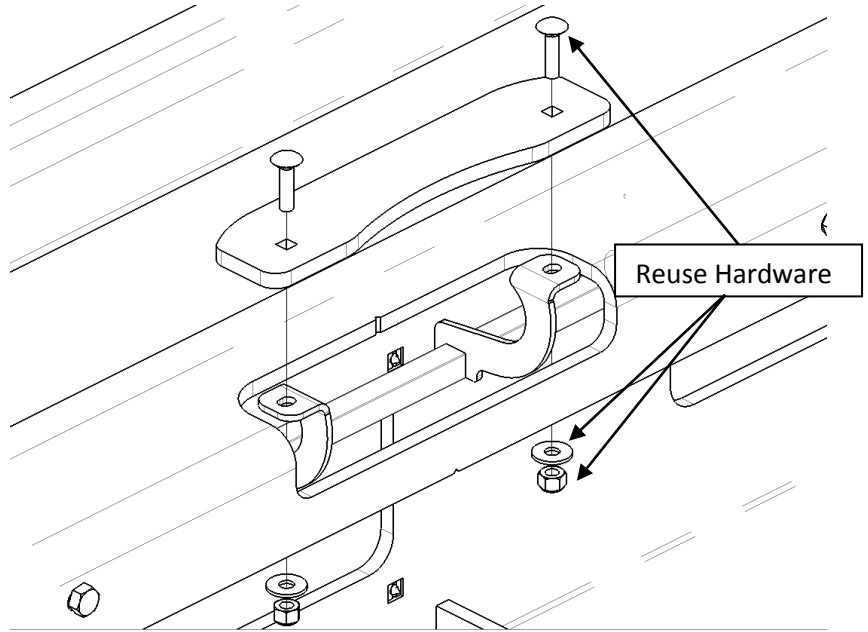

Figure 6 – Slam Latch Handle Reassembly

Important

- The Herd Slam Latch requires adjustment. Proceed with the following steps for instructions on how to properly adjust your Slam Latch.

7. Open bumper and make sure that the $\frac{1}{4}$ " Slam latch Hanger fasteners are loose enough to allow for sliding in the slots.

The slam latch hangers can be adjusted front to back using the adjustment bolts on either side of the bumper. Rotating the bolts CCW results in tightening while CW results in loosening.

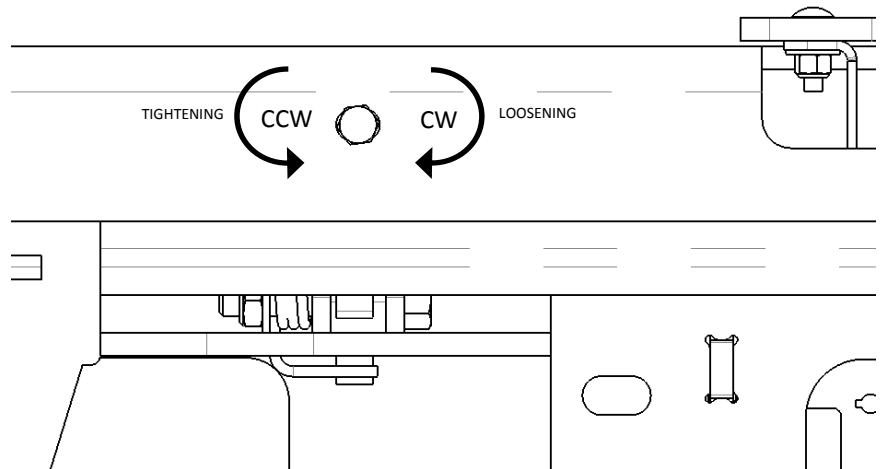

Figure 7 – Slam Latch Hanger Adjustment (driver's side shown).

8. Tighten the slam latch adjustment bolt and then fully tighten the Slam Latch Hanger fasteners (Items 3 & 4). Close the bumper to check tightness of the latch.

The goal of the adjustment is to tighten the latch enough to eliminate any rattle while still having the latch fully engage.

Repeat this step until the latch mechanism is sufficiently firm.

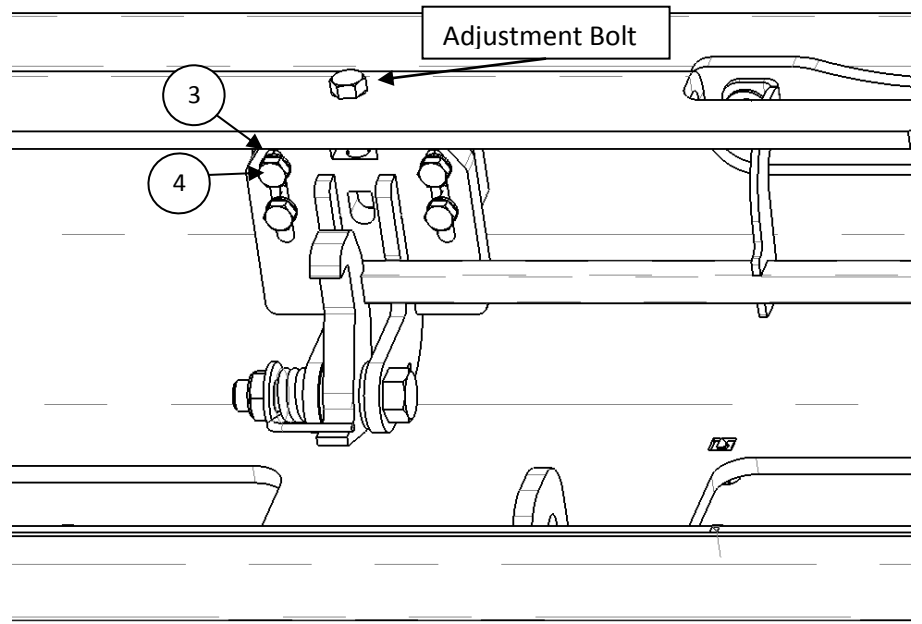

Figure 7 – Slam Latch Hanger Adjustment (driver's side shown).

9. The Slam latch has a primary ramp and secondary ramp. Overtightening the slam latch may result in not being able to engage the primary ramp. If the latch does not fully engage, it is too tight.

If too tight, loosen the adjustment bolt and return to step 8.

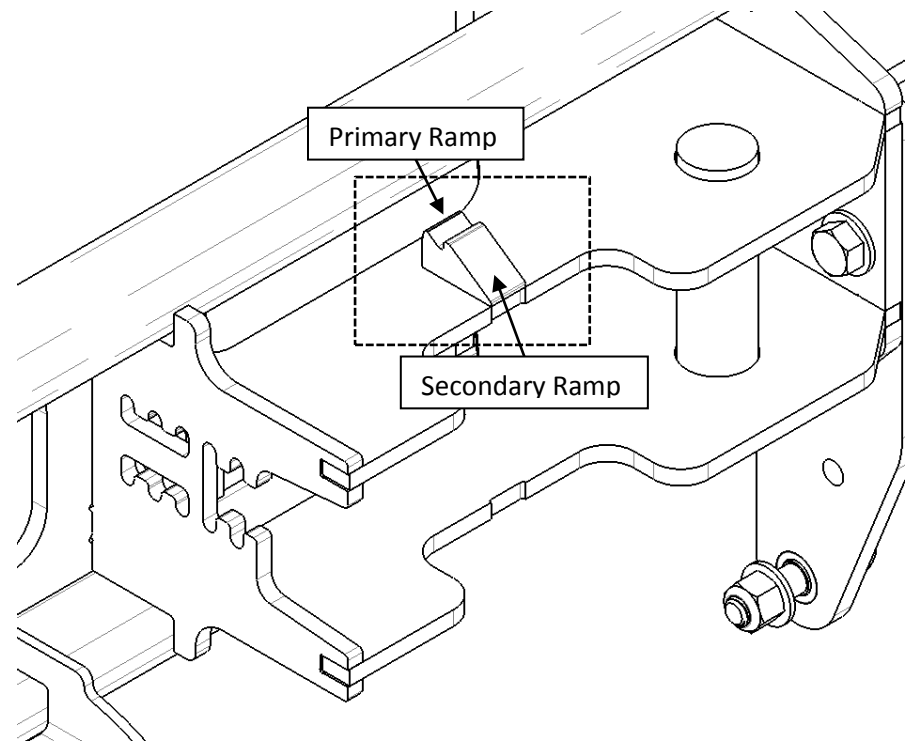

Figure 9 - Slam Latch Ramp (driver's side shown).