

# HERD FL33G2/G3 Installation Procedure

- This document shows how to install your new Grille Guard onto your truck.
- Ensure that you have completely read and understand document **S017 - Safety** before beginning this installation procedure.

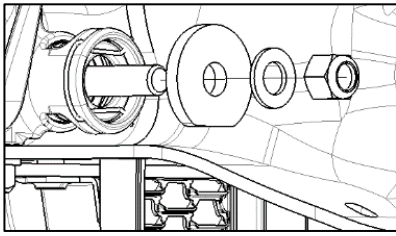

Figure 1b: Rear view of tow receiver

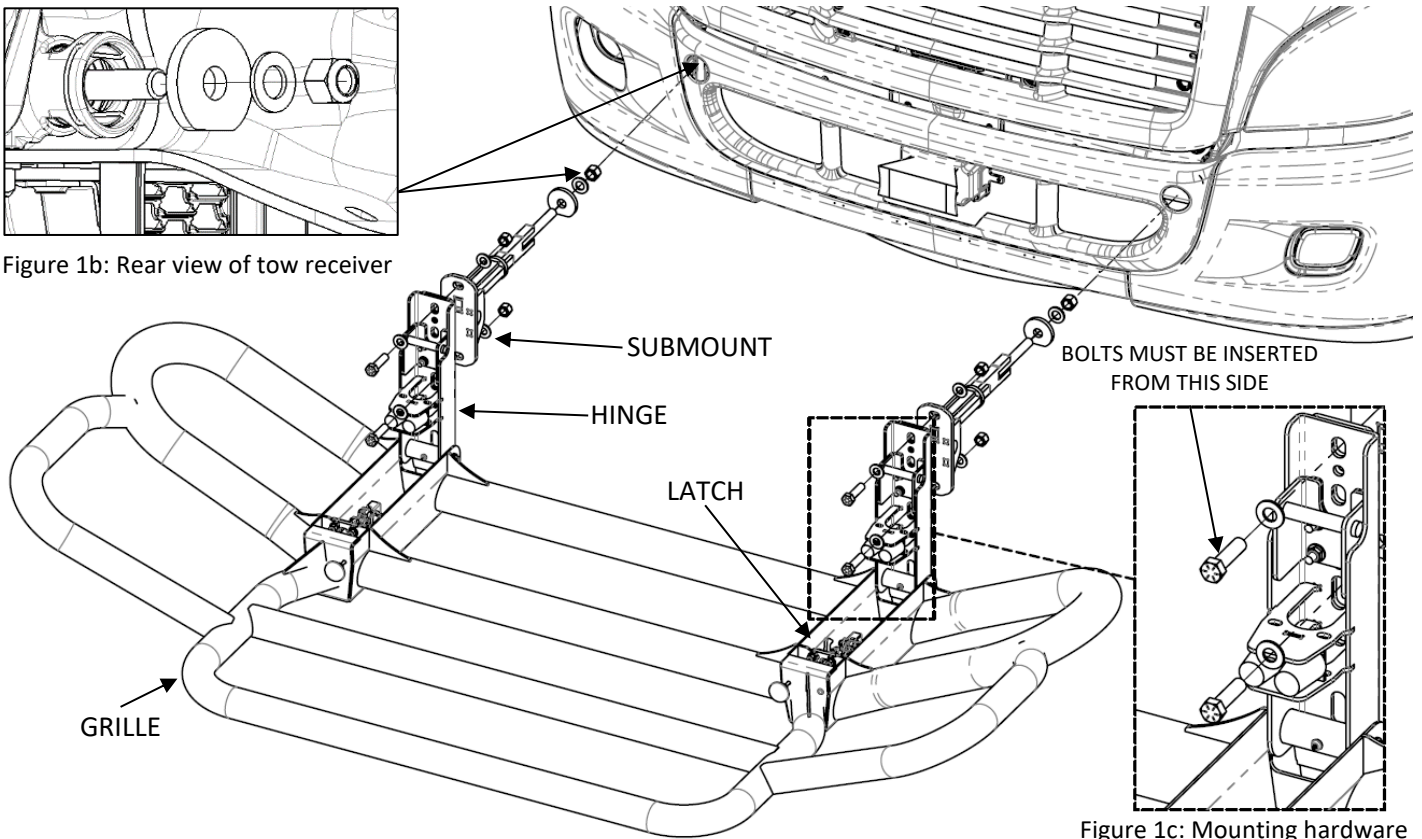

Figure 1c: Mounting hardware

Figure 1a: Grille Guard installation (Your Grille Guard may not be exactly as shown)

1. Insert Submounts into truck's tow receiver. **See Figure 2a, 2b and 2c for the specific orientation of the Submounts based on the make and model of your truck and type of hinge (A or B) of Grille Guard.**

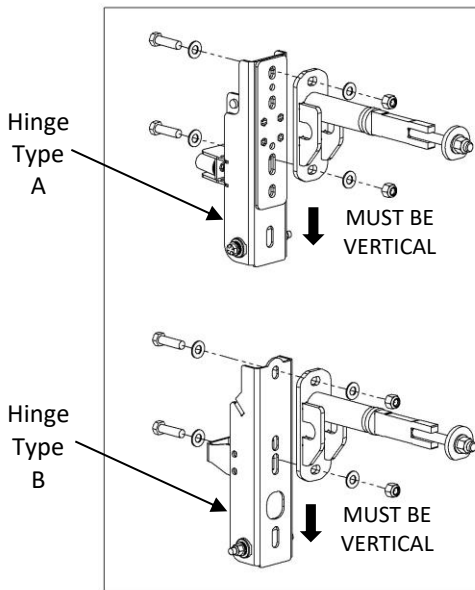

Figure 2a: For Freightliner Cascadia Classic Narrow Rad

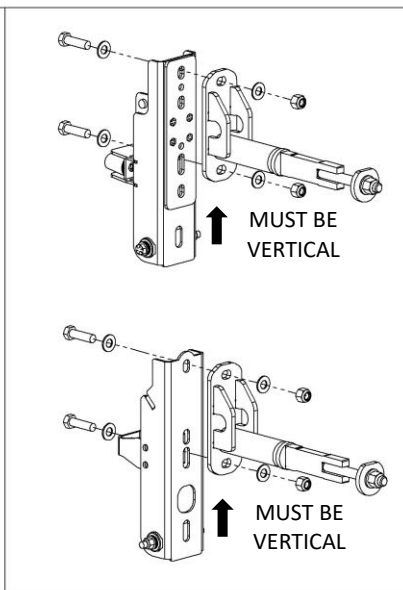

Figure 2b: For Western Star 4700-SBA

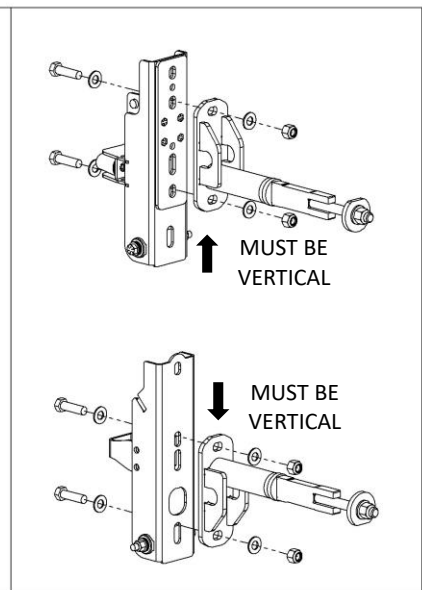

Figure 2c: For Freightliner 114 SD SBA

2. Open hood of truck. From inside front wheel wells, secure driver and passenger side Submounts with fasteners shown in Figure 1b:
  - a) Tighten lock nut until Submount is fully seated against front face of tow receiver.
  - b) Loosen lock nut until large washer becomes slightly loose, then **check if the Submount is vertical**.
  - c) **Torque lock nut to 240 ft-lb**. If there is no access for a torque wrench, turn lock nut 3/4 of a turn after the lock nut is seated against the washers.
3. Lay Grille flat on ground in front of truck on a pallet or protective sheet.
4. Open driver side Hinge and lift to driver side Submount. Hand tighten upper hardware shown in Figure 1a (**do not fully tighten**). Repeat for passenger side. **Ensure bolts are inserted from front (Hinge side) as shown in Figure 1c**.
5. Assemble lower hardware on both sides. Hand tighten hardware (**do not fully tighten**). After all four fasteners have been assembled, **torque to 110 ft-lb**, starting with upper hardware.
6. Please proceed to document **S018 – Grille Guard Latch Adjustment Procedure** for Latch adjustment.

**Important: Check mounting point's hardware after the first 5000 km and every 3-6 months. Re-torque if necessary.**