



INSTALLATION INSTRUCTIONS

KENWORTH

Item #	Vehicle Description
KW13	KW T800 LOGGER SBA (1986-2014)

IMPORTANT

- A** Herd Bullbars are vehicle "Make & Model" specific. Use of a bullbar on a vehicle other than the model it was designed for will constitute improper use of the product and may void warranty.
- B** Unless otherwise specified, Grade 8 hardware is to be used. For the purposes of these instructions, OE hardware means the truck's original factory hardware.
- C** The drop-forged eyebolts are an integral part of the strength of Herd bullbars. When tightened firmly, they will minimize vibration and provide superior impact resistance.
- D** To help maintain the factory finish, avoid acid wash.

Step

- 1 *Remove factory tow pin and place it sideways in the receiver to allow removal of factory bumper.*



2 *Remove lower bumper mounts from the factory tow section on each side, see picture below.*



3 *Remove the top bumper mounting bolts, see picture below*



4 *Remove OEM bumper*

5 Remove OEM tow hitch, see pictures below

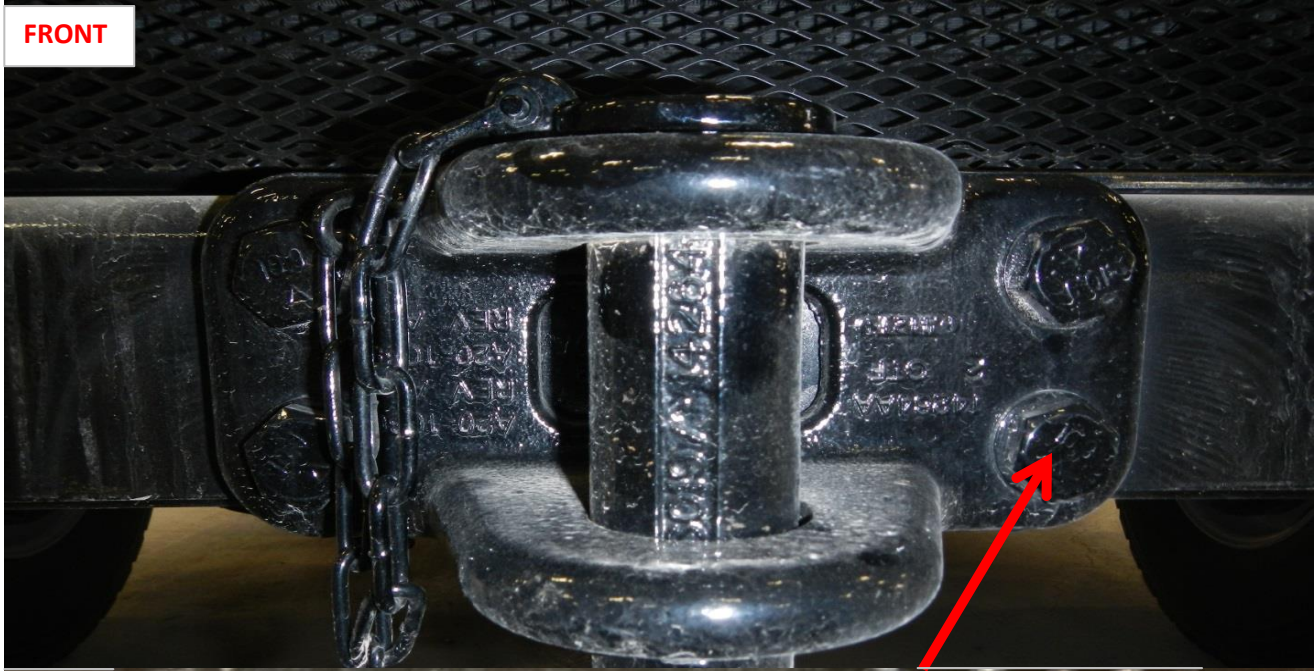

6 Remove the 6 small bolts across the front end of the OEM cross member

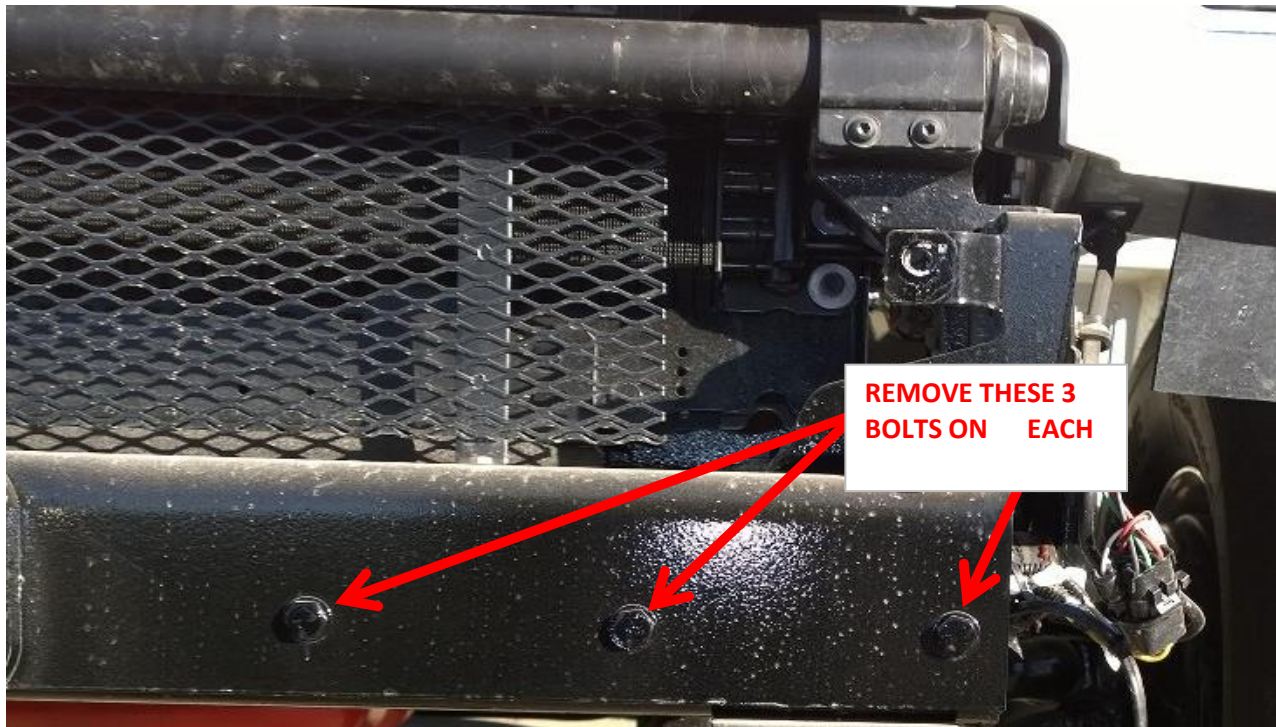

7 Remove HERD steel bracket from the bumper

8 Install steel bracket on to truck using supplied and OEM hardware (ensure all mounting locations are used) see picture below

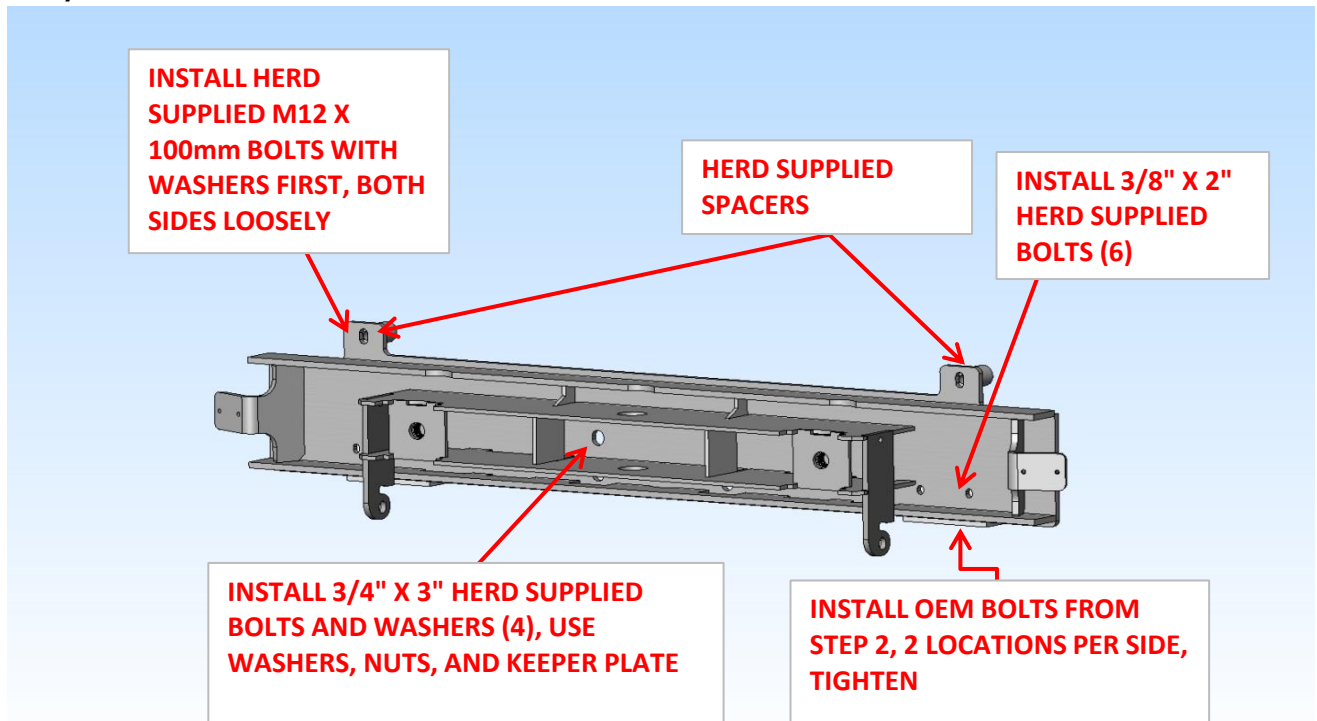

9 Tighten remaining bolts

10 Attach bullbar to bracket using Herd supplied hinge bolts

* For DFLT & Defender models only: To install the hinge bolts, the bumper must be in the open (down) position to allow the bottom lip to go under and around the steel hinge.

11 Re-check the mounting bracket and bolts after the first 5,000km and every 3-6 months.

Eyebolts are secured in the channel with a 7/8" rubber washer. If you need to re-install the washer, insert the eyebolt into the hole, and thread a washer onto the back side of the eyebolt, approximately halfway onto the threaded part of the eyebolt.