

- This document shows how to install your new Grille Guard onto your truck.
- Ensure that you have completely read and understand document **S017 - Safety** before beginning this installation procedure.

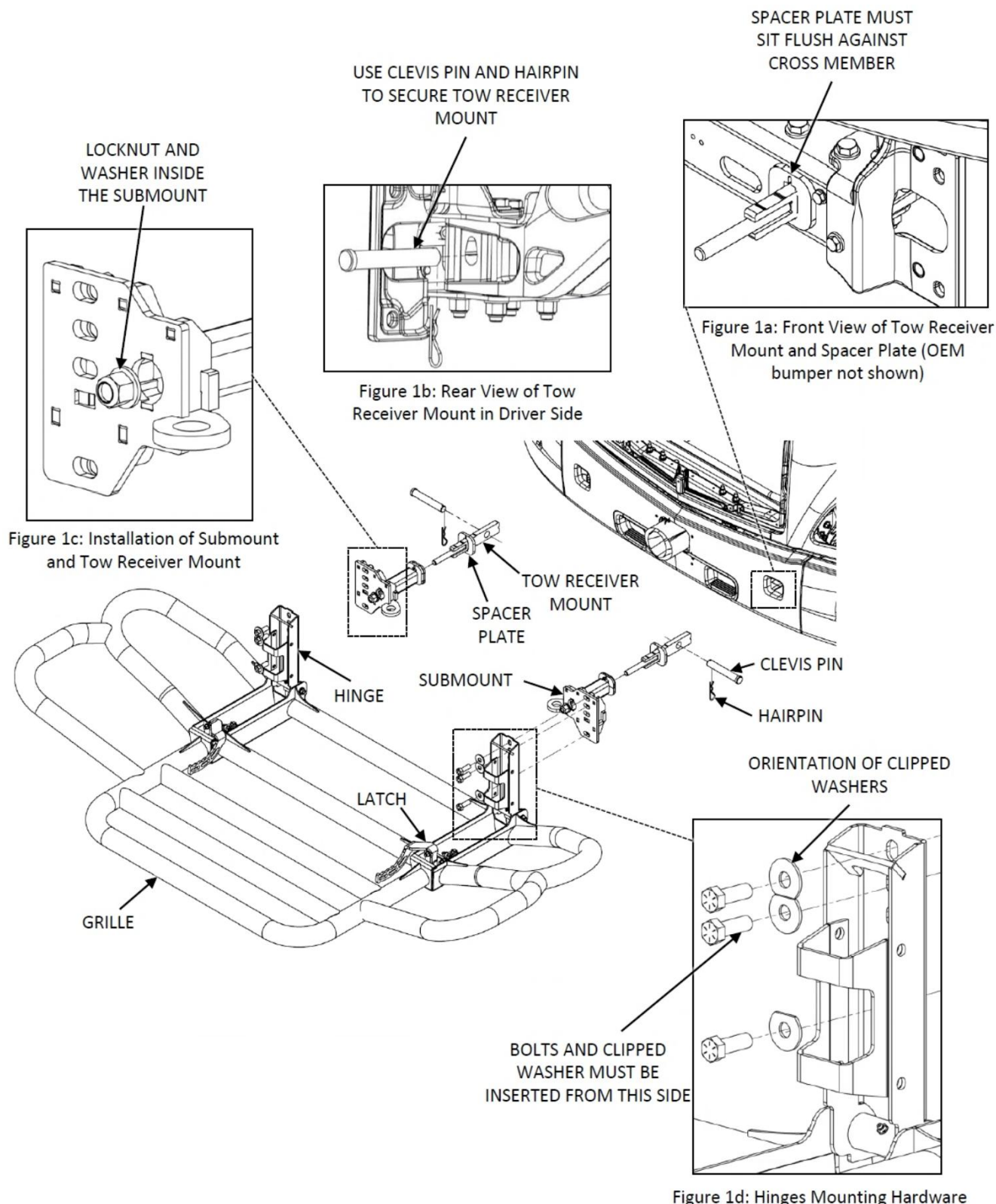

Figure 1: Grille Guard Installation (Your Grille Guard and Truck may not be exactly as shown)

1. Install Tow Receiver Mount into truck's tow receiver as shown in Figure 1a. Secure using provided Clevis Pin and Hairpin as shown in Figure 1b. Perform this step on both driver and passenger sides.
2. Install Spacer Plate into Tow Receiver Mount, and ensure it sits flush against the truck's crossmember as shown in Figures 1a. Refer to Figure 2 for Spacer Plates configuration based on the make, model and crossmember configuration of your truck.

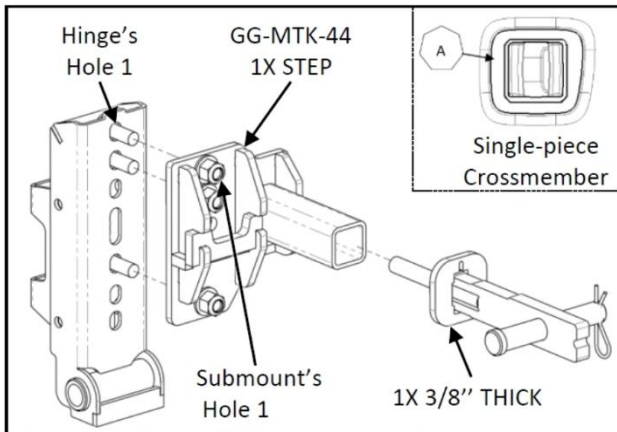

Figure 2a: Peterbilt 579 with Single-piece Crossmember

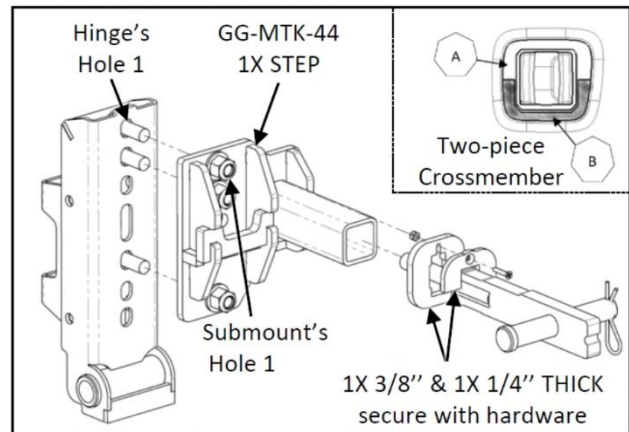

Figure 2b: Peterbilt 579 with Two-piece Crossmember

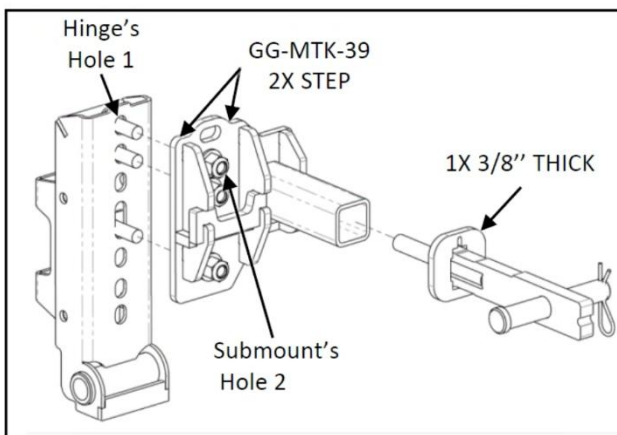

Figure 2c: Kenworth T680

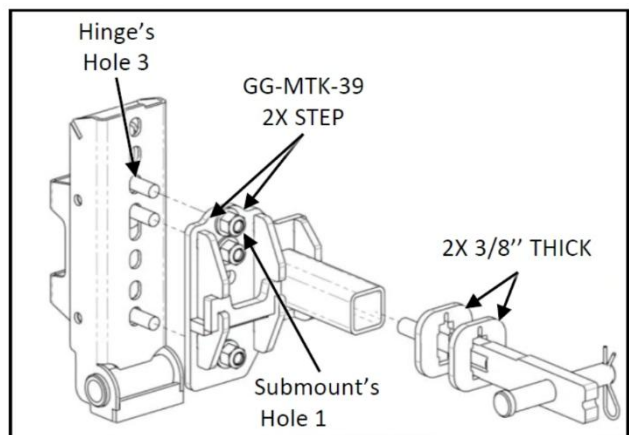

Figure 2d: Kenworth T880

Figure 2: Installation of Spacer Plate, Submount and Hinge.

3. Insert Submount into Tow Receiver Mount against the Spacer Plates and secure it using the provided 3/4" lock nut, as shown in Figure 1c. Tighten lock nut until Submount is fully seated against front face of tow receiver. **Torque to 240 ft-lb.** If there is no access for a torque wrench, turn lock nut 3/4 of a turn after it is seated against the washers. Repeat for the other side.
4. Lay Grille flat on ground in front of truck on a pallet or protective sheet.
5. Open driver side Hinge and lift to driver side Submount. See Figure 2 for Hinge and Submount's hole location based on the make, model and crossmember configuration of your truck. Hand tighten upper 5/8" hardware (**do not fully tighten**). **Ensure bolts and clipped washers are inserted from front (Hinge side)** as shown in Figure 1d. Repeat for the other side.
6. Assemble lower 5/8" hardware on both sides. Hand tighten hardware (**do not fully tighten**). Open hood of truck and check no interference with hood and Hinges. After all six fasteners (three per side) have been assembled, **torque to 110 ft-lb**, starting with upper hardware.
7. Please proceed to document **S021 – Grille Guard New Style Latch Adjustment Procedure** for Latch adjustment.

Important: Check mounting point's hardware after the first 5000 km and every 3-6 months. Re-torque if necessary.